

83 Pass
35 Pass

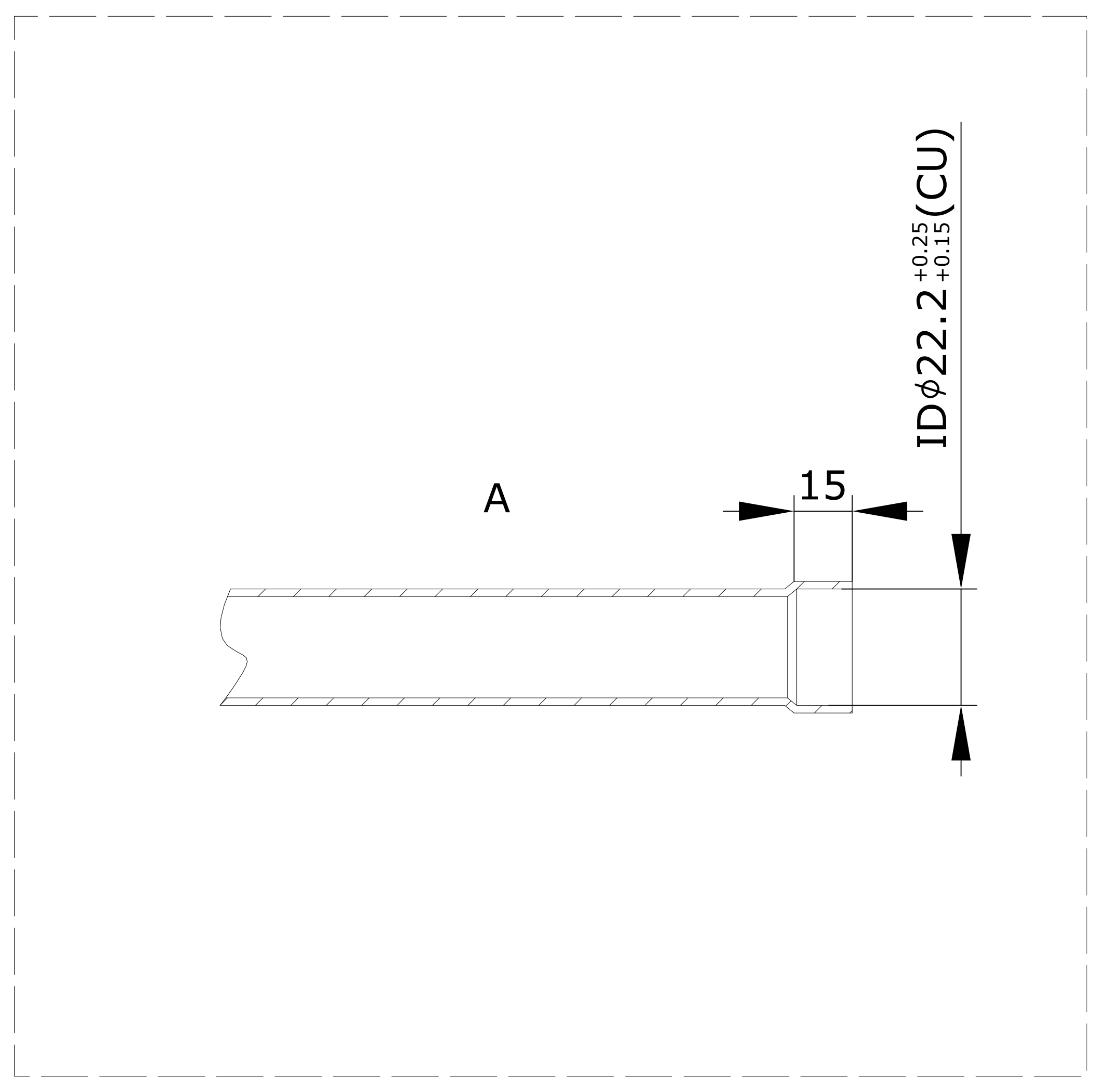

- NOTES
- DESIGN PRESSURE 4.5MPA;
 - THE MINIMUM BURST PRESSURE OF THE PRODUCT IS THREE TIMES THE DESIGN PRESSURE
 - DIAGONAL DIFFERENCE MAX 7mm;
 - TOLERANCE IF NOT SPECIFIED SHALL COMPLY WITH STANDARD ISO 2768-1 CLASS C(GB/T 1804 CLASS C)
 - SEAL 0.01~0.05MPA NITROGEN GAS IN THE PRODUCT
 - OTHER STANDARDS JB/T11967 EN378-2.
 - THE INLET AND OUTLET PIPES ARE COPPER PIPES

PRODUCT PARAMETERS	
TUBE NUMBER	118
TUBE TYPE	25.4*2- 20
TUBE MATERIAL	LLA9153(3F03)+Zn- H112
(LONG USING LIFE ALLOY)	$\phi 38$
MANIFOLD TYPE	LOUVERED 25.4*0.08 FPI 23
FIN TYPE	AA4343/3003/4343
FIN MATERIAL	83/35
PASS	

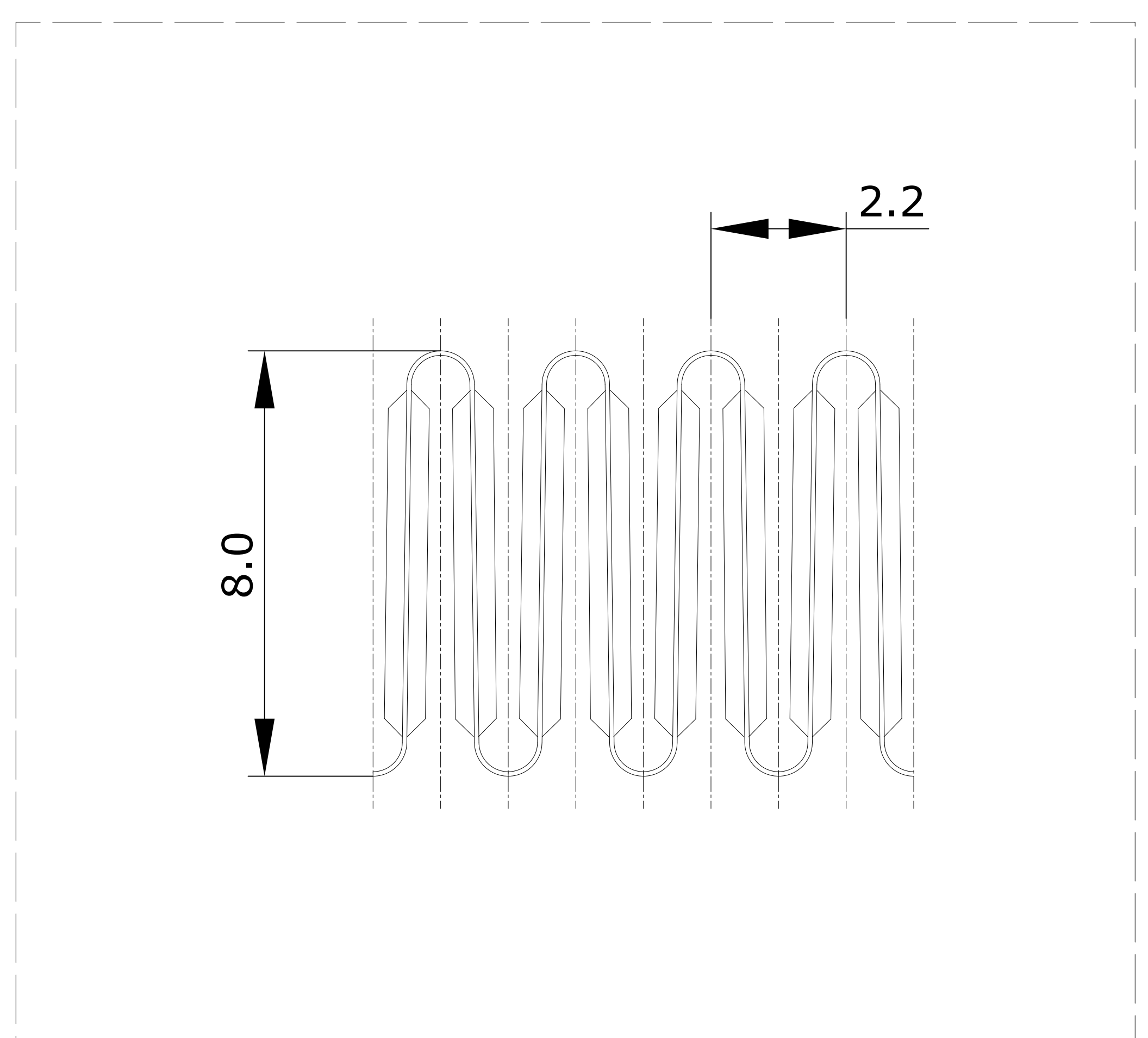

UNMARKED TOLERANCE X ±1.5 X.X ±1 X.XX ±0.5 ∠ ±1°	DESCRIPTION: Microchannel heat exchanger	
	MODEL: RC-1800-I	REV. A
VIEW ⊕ □	CODE: 021U0097R	CREAT: AUDIT:
	APPROVED BY CUSTOMER SIGNATURE:	PROCESS: APPROVE: